

BEAM SCHEDULE		
BEAM MKD.	SECTION AT SUPPORT (M25)	SECTION AT SPAN (M25)
B1 (200x600)	2-25 ϕ (ath), 2-20 ϕ (ext), 12 ϕ @100c/c, 2-25 ϕ (ath)	2-25 ϕ (ath), 12 ϕ @150c/c, 2-20 ϕ (ext), 2-25 ϕ (ath)
B2 (200x600)	2-20 ϕ (ath), 2-20 ϕ (ext), 10 ϕ @100c/c, 2-20 ϕ (ath)	2-20 ϕ (ath), 10 ϕ @150c/c, 2-20 ϕ (ext), 2-20 ϕ (ath)
B3 (250x600)	3-20 ϕ (ath), 2-16 ϕ (ext), 12 ϕ @100c/c, 3-20 ϕ (ath)	3-20 ϕ (ath), 12 ϕ @150c/c, 2-16 ϕ (ext), 3-20 ϕ (ath)
B4 (200x600)	2-20 ϕ (ath), 10 ϕ @125c/c, 2-20 ϕ (ath)	2-20 ϕ (ath), 10 ϕ @125c/c, 2-20 ϕ (ath)
B5 (200x600)	2-25 ϕ (ath), 10 ϕ @125c/c, 2-25 ϕ (ath)	2-25 ϕ (ath), 10 ϕ @125c/c, 2-25 ϕ (ath)

REINF. SCHEDULE	
REINF. MKD.	SPACING
a	8 ϕ @125c/c (bot.st.)
b	8 ϕ @125c/c (top st.)
c	8 ϕ @150c/c (bot.st.)
d	8 ϕ @150c/c (top st.)
e	8 ϕ @100c/c (bot.st.)
f	8 ϕ @100c/c (top st.)

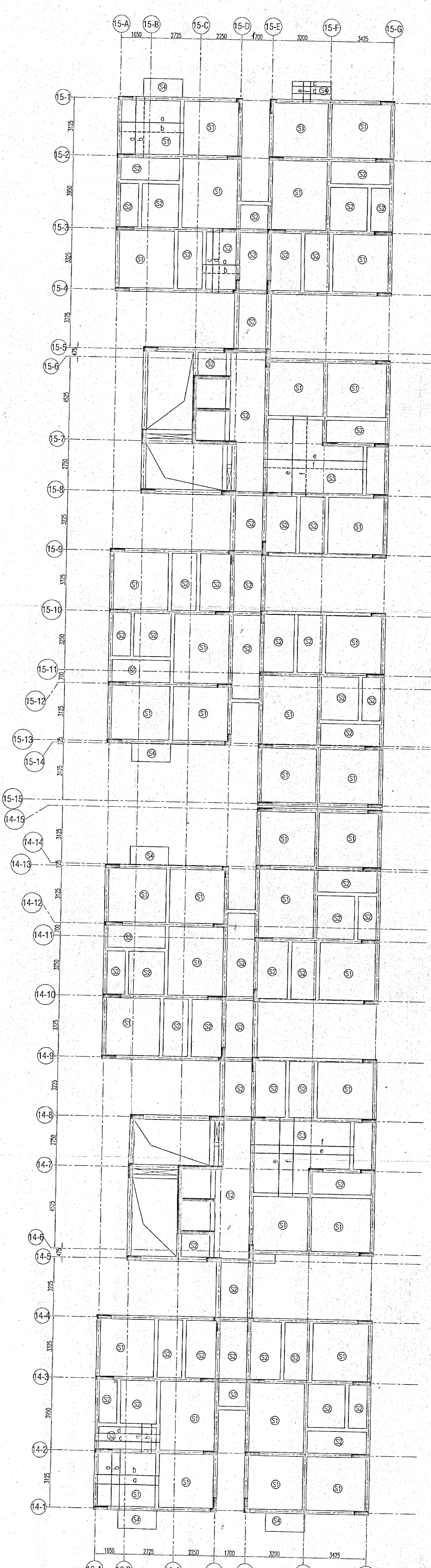
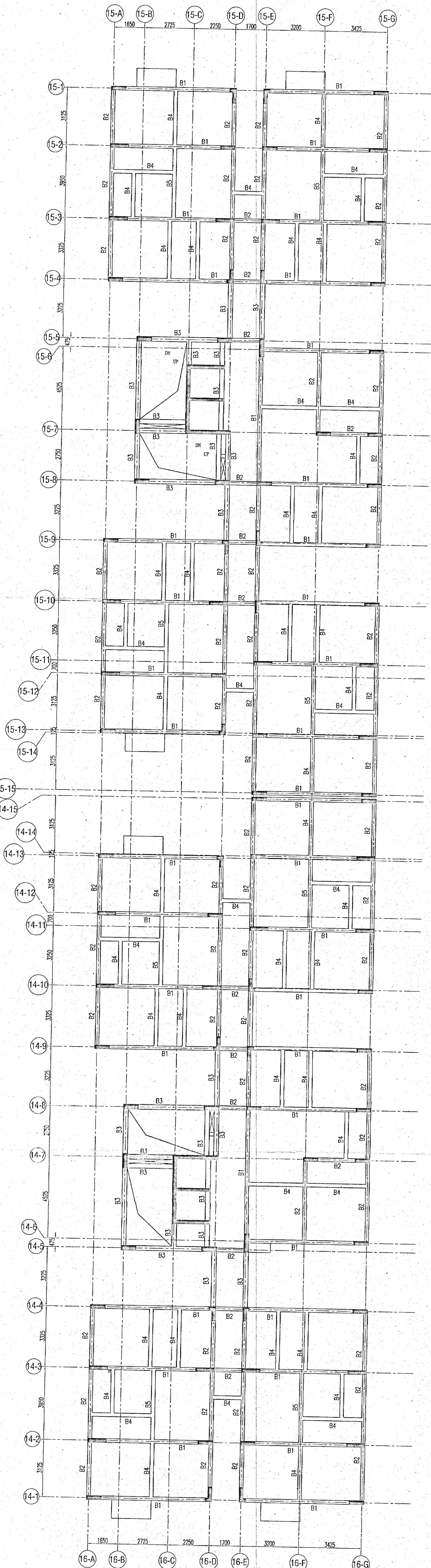

SIGNATURE OF OWNER
I/WE CONFIRM THAT THE ERECTION OF BUILDING TO BE UNDERTAKEN SHALL BE STRICTLY IN ACCORDANCE WITH THE WEST BENGAL MUNICIPALITY BUILDING RULES 2007 & AMENDMENT 2016.

MAGNOLIA INFRASTRUCTURE DEVELOPMENT LTD.
Director

SIGN. OF OWNER

CERTIFICATE OF ARCHITECT

I CERTIFY THAT ALL THE ARCHITECTURAL DRAWINGS OF THE PROJECT AT R.S. DNO NOS. - 1507, 1508, 1510, 1550, 1551, 1556, 1555, 1556, 1581, 1582, 1583, 1545, 1546, 1584, 1585, 1581, 1583, 1584, 1511, 1512, L.R. KHATIAN NOS. - 4912, 4613, MOUZA - JADAVPUR, P.L. NO - 9, UNDER P.S - TITAGARH, DIST - NORTH 24 PARGANAS, HAVE BEEN PREPARED BY ME & CERTIFY THAT THE PLANS AND DRAWINGS COMPLYING WITH ALL THE PROVISIONS REGARDING THE FIRE PROTECTION AS PER THE WEST BENGAL MUNICIPALITY BUILDING RULES 2007 & AMENDMENT 2016. I SHALL BE HELD RESPONSIBLE IF ANY INCORRECT INFORMATION IS FURNISHED BY ME OR ANY VIOLATION OF PROVISIONS OF THESE RULES OR THE PREVAILING NATIONAL BUILDING CODE IS FOUND IN ANY OF THE DRAWINGS AND DOCUMENTS, SIGNED BY ME AND SUBMITTED TO THE SANCTIONING AUTHORITY FOR OBTAINING SANCTION.

Rajkumar Agarwal
Architect
Member of Council of Architecture CA / 94 / 17940

SIGN. OF ARCHITECT
RAJKUMAR AGARWAL
COUNCIL REGISTRATION NO. CA/94/17940
ADDRESS:
RAJ AGARWAL & ASSOCIATES
8B, ROYD STREET (2ND FLOOR), KOLKATA-16.

IT IS HEREBY CERTIFIED THAT THE STRUCTURAL DRAWINGS ARE PREPARED FOR EARTHQUAKE RESISTANCE IN ACCORDANCE WITH THE WEST BENGAL MUNICIPALITY BUILDING RULES 2007 & AMENDMENT 2016.

SIGN. OF GEO-TECHNICAL ENGINEER

CERTIFICATE OF STRUCTURAL ENGINEER

I CERTIFY THAT THE STRUCTURAL DRAWING & DESIGN OF BOTH FOUNDATION & SUPER STRUCTURE OF THE BUILDING / BUILDINGS HAS BEEN MADE CONSIDERING THE SOIL TEST REPORT, AS PER THE RULES AND REGULATIONS MADE UNDER THE ACT AND ALSO CONSIDERING ALL POSSIBLE LOADS, SEISMIC LOAD AND THE MOMENTS GENERATED BY THE PROPOSED STRUCTURE AS PER THE BUREAU OF INDIAN STANDARD AND NATIONAL BUILDING CODE OF INDIA AND CERTIFIED THAT IT IS SAFE & STABLE IN ALL RESPECT AND THESE PROVISIONS SHALL BE ADHERED TO DURING THE CONSTRUCTION.

Mainak Majumdar
B.C.E., M.C.E. (Struct)
ESE-1522
STR/NKDA/10/0020
STR/NKDA/14/0001

SIGN. OF STRUCTURAL ENGINEER

PROJECT
PROPOSED ADDITION OF THREE BUILDING (BLOCK 13,14 & 15) (BLOCK-1, 2, 3, 4, 5, 6, 7 & 8 ALREADY SANCTIONED) FOR G+VII STORED (25.0 MT. HT.) RESIDENTIAL BUILDING OF MAGNOLIA SPORTS CITY, D.NO. - 1507, 1508, 1510, 1550, 1551, 1550, 1565, 1566, 1581, 1582, 1583, 1545, 1546, 1584, 1585, 1561, 1563, 1564, 1511, 1512, L.R. KHATIAN NOS. - 4612, 4613, MOUZA - JADAVPUR, P.L. NO - 9, UNDER P.S - TITAGARH, DIST - NORTH 24 PARGANAS.

STRUCTURAL CONSULTANT
ADROIT CONSULTANT
10/3 PANCHANANTALA MAIN ROAD
KOLKATA-700029

ARCHITECT
RAJ AGARWAL & ASSOCIATES
8B, ROYD STREET, KOLKATA-16

SANCTION DRAWING			
SCALE	TITLE	DATE	BY
1:100, 1:25	TYPICAL FLOOR BEAM, SLAB LAYOUT & SCHEDULE	STAR/2016/11	STAR/2016/11
DESIGNED	R.H.	2016-05-06	STAR/2016/11
DRAWN	R.H.	2016-05-06	STAR/2016/11
CHECKED	R.H.	2016-05-06	STAR/2016/11

THIS STRUCTURAL DRAWING IS VETTED BY PROFESSOR DR. PARTHA GHOSH OF JADAVPUR UNIVERSITY (J.U.), KOLKATA

Checked & Vetted
Dr. Partha Ghosh
B.E., (CIVIL), M.E. (Structural Engg.), Ph.D. (Engg)
Professor
Commissioning Dept. Jadavpur University, Kolkata-700 106

SIGNATURE OF PARTHA GHOSH